

Starck 3 Washbasin # 0303480000 / 0303480030

< 18 7/8" Inch >

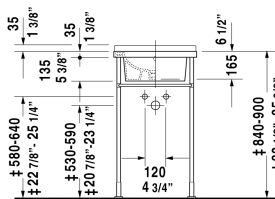
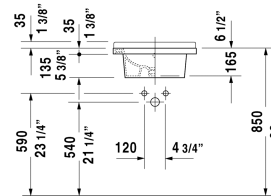
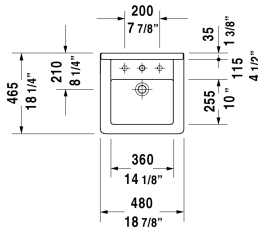

Washbasin	Dimension	Weight	Order number
with overflow, with faucet deck, underside fully glazed, hardware included, wall-mounted, cUPC® listed*, 18 7/8" Inch			
Colors			
00 White			
Variant			
●	18 7/8" x 18 1/4" Inch	27.5 lb	0303480000
● ● ●	18 7/8" x 18 1/4" Inch	27.5 lb	0303480030
Infobox			
* Complies with following standards: ASME A112.19.2/CSA B45.1, Metal console is mandatory for installation			
Sanitary ceramics with the special WonderGliss surface finish will remain clean and attractive-looking for a long time to come. When ordering WonderGliss please add a "1" as eleventh digit to the model number.			
Suitable products			
Metal console height adjustable +2", for furniture basin # 030348,			003064
Vanity unit wall-mounted 2 drawers, upper drawer including cut-out for siphon and siphon cover, countertop including one cut-out, for 1 vanity basin centered, 31 1/2" x 21 5/8" Inch	31 1/2" x 21 5/8" Inch		KT6754
Vanity unit wall-mounted 1 door, for Starck 3 # 030348, 18 1/8" x 17 1/2" Inch	18 1/8" x 17 1/2" Inch		BR4040 L/R

All drawings contain the necessary measurements which are subject to standard tolerances. They are stated in inch & mm and are non-



Starck 3 Washbasin # 0303480000 / 0303480030

|< 18 7/8" Inch >|

binding. Exact measurements, in particular for customized installation scenarios, can only be taken from the finished ceramic piece.