

INSTALLATION MANUAL

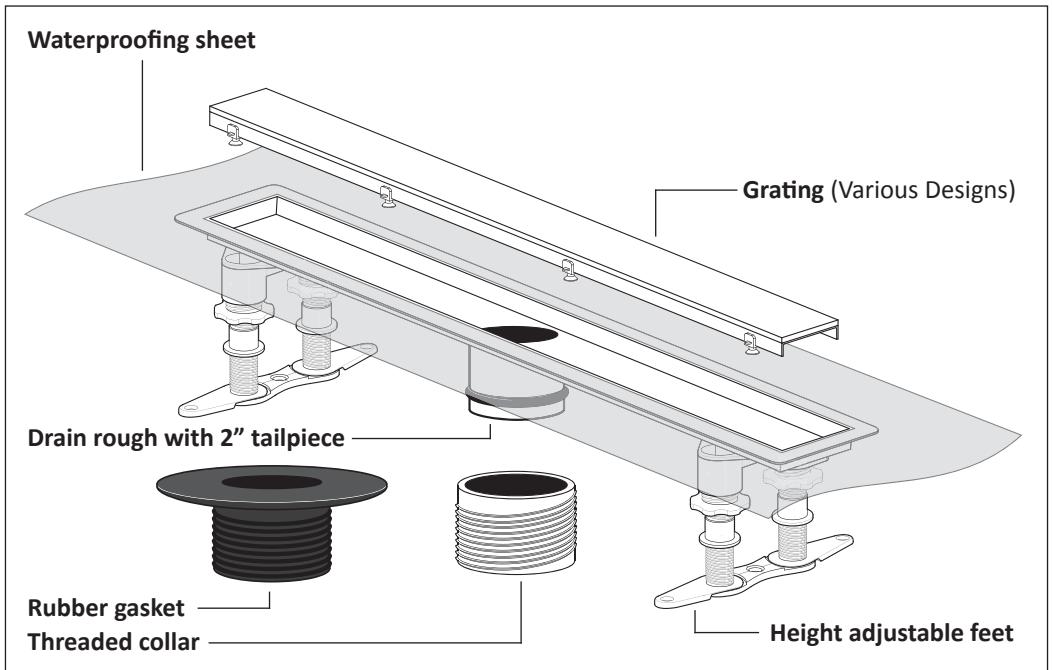

Important: Installer must verify that the drain package is complete and check all rough dimensions prior to installation. Installer should consult local and national standards and is responsible for installing the drain in compliance with local and national codes.

Installation guide | Height adjustable feet

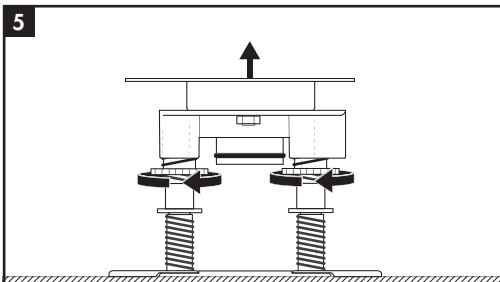
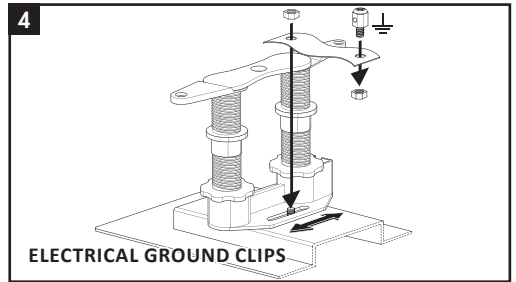
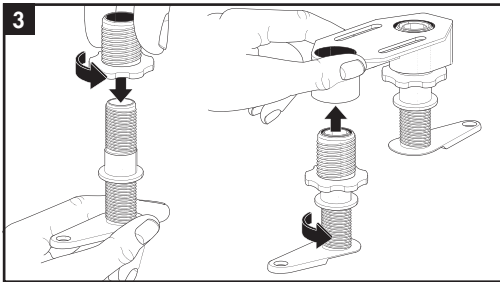
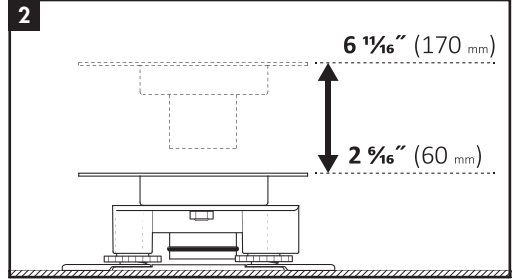
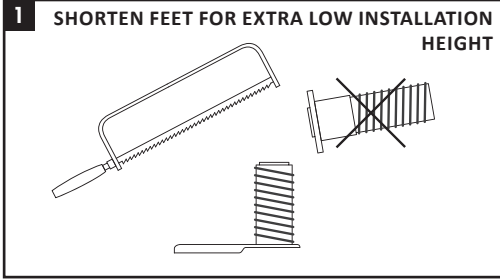

Height adjustable feet | Wall mounted

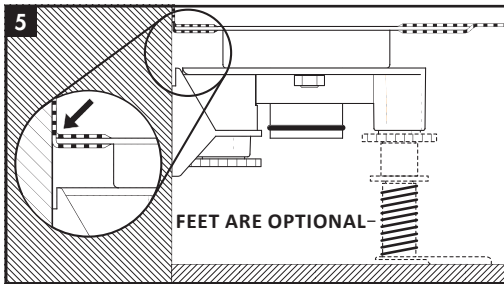
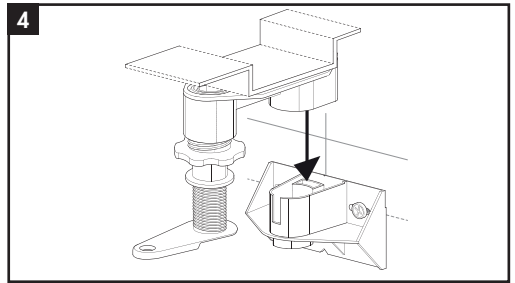
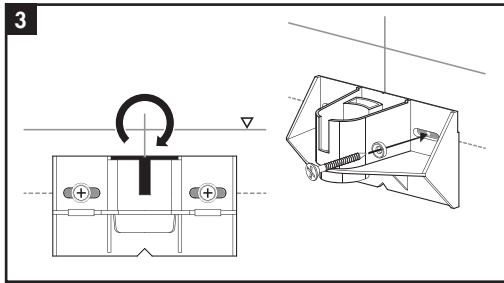
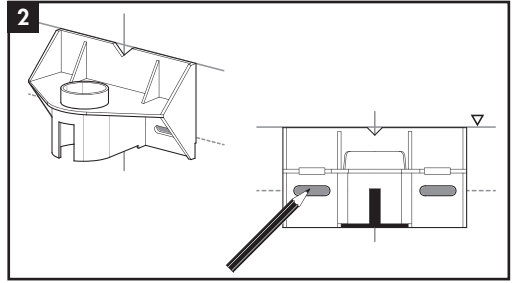
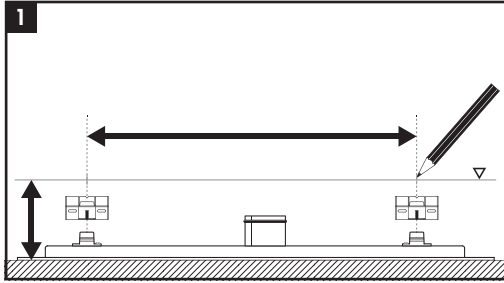

Installation guide | Standard clamp drain

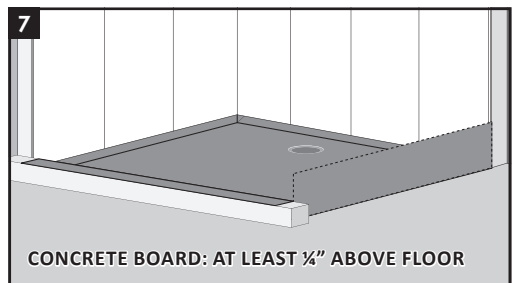
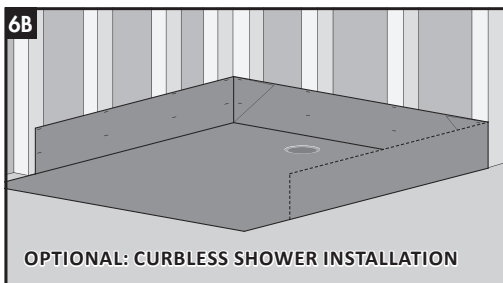
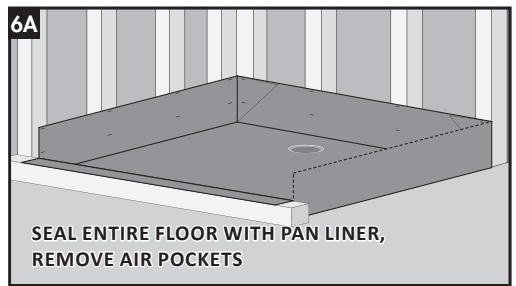
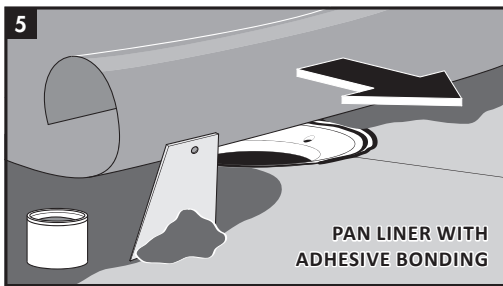
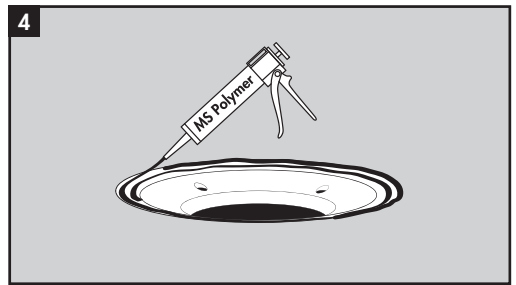
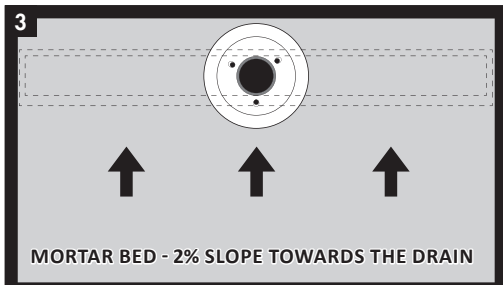
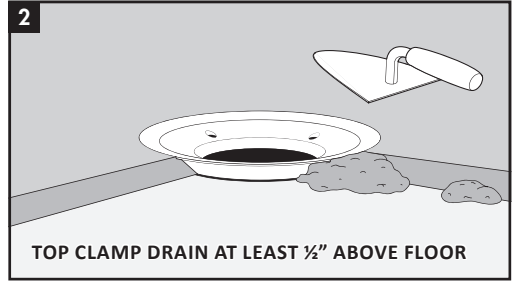
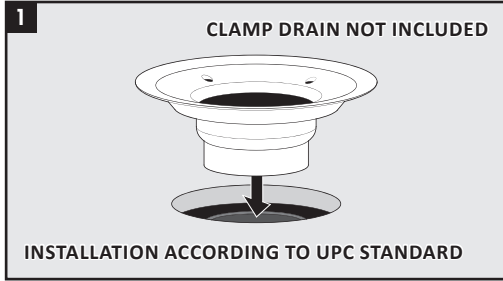

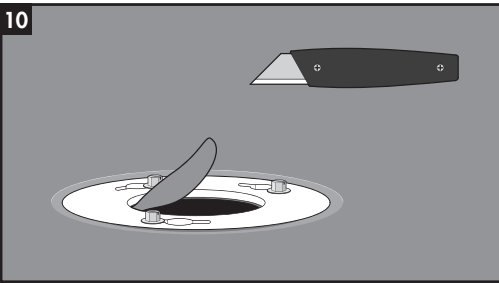
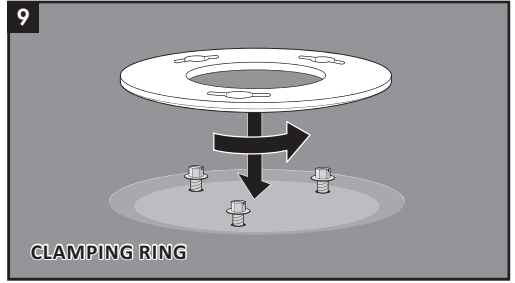
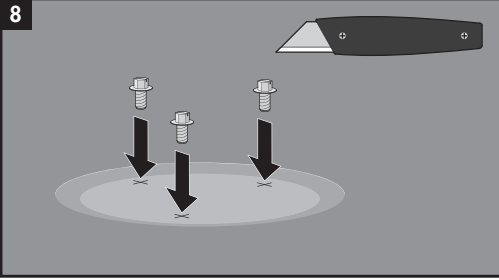

>> CONTINUE ON PAGE 6

Installation guide | Linear shower drain

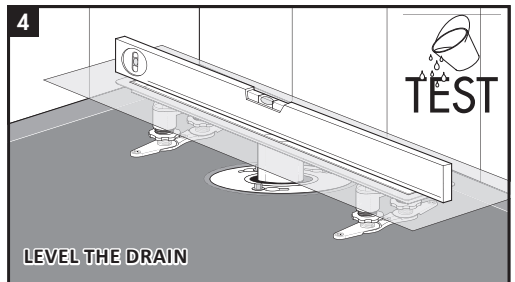
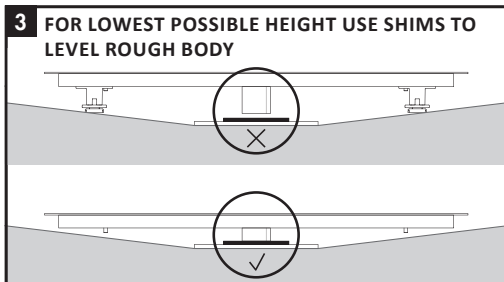
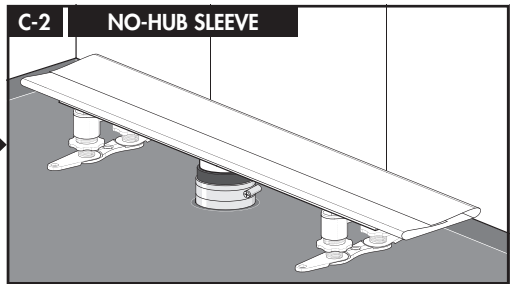
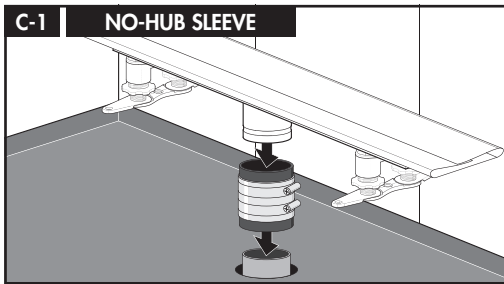
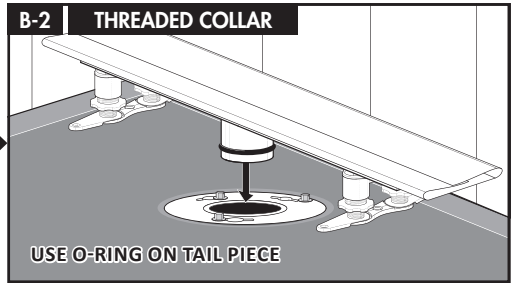
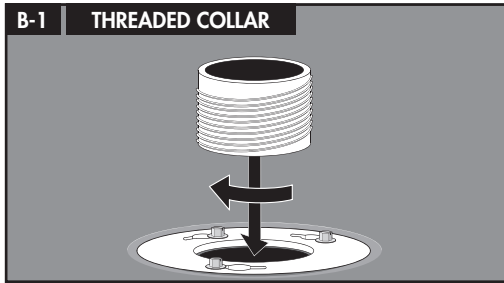
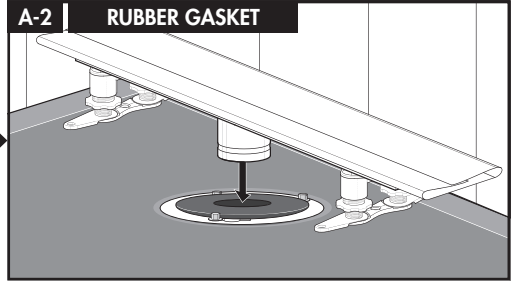
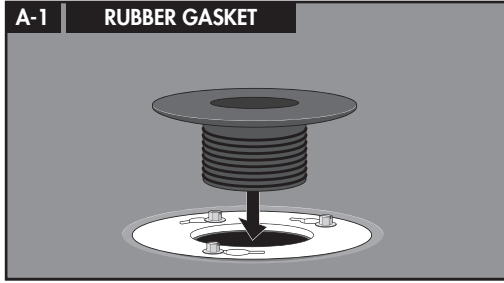

Installation guide | Drain placement

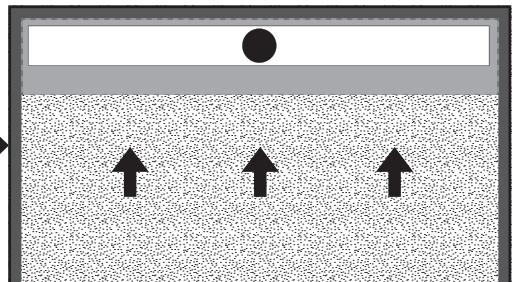
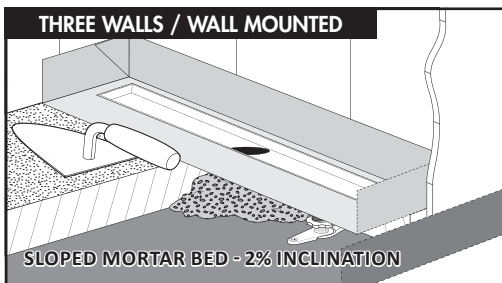
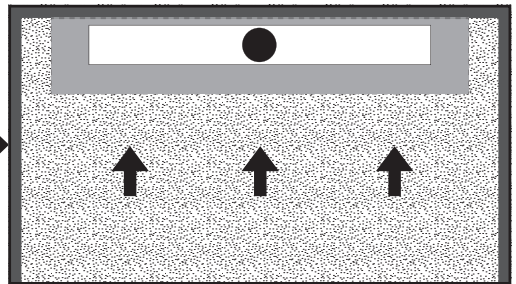
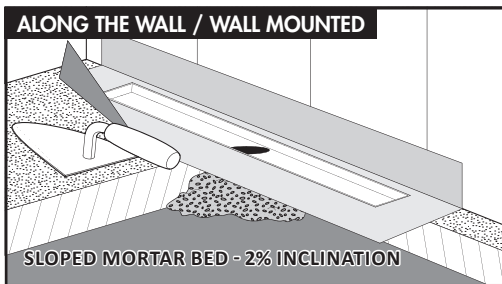
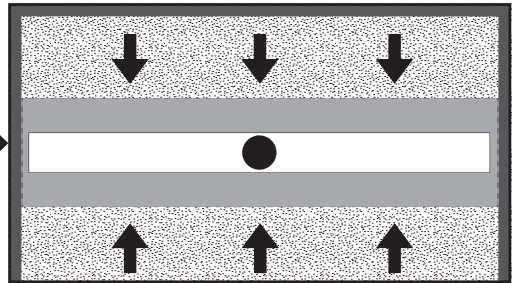
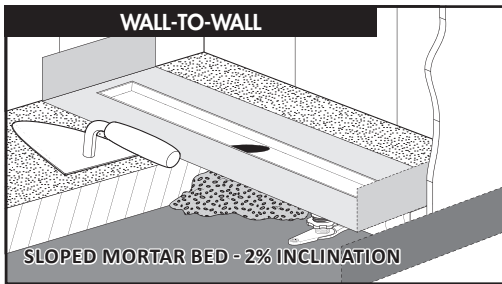
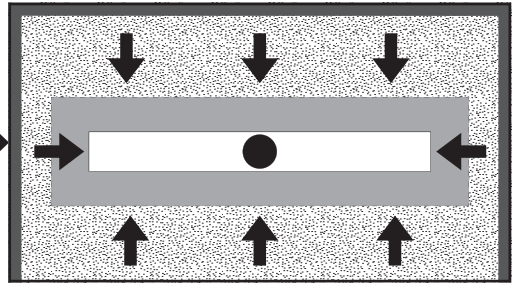
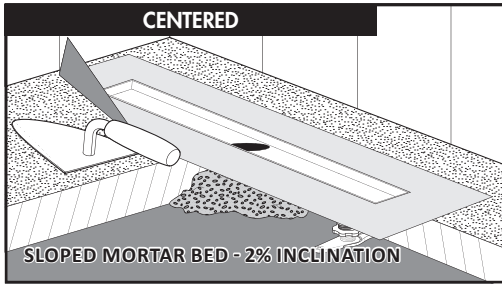

Installation guide | Sealing & waterproofing

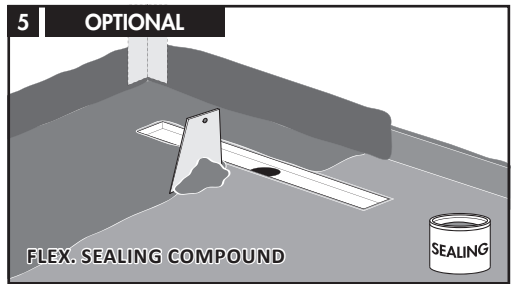
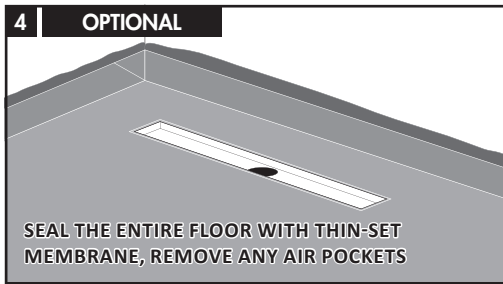
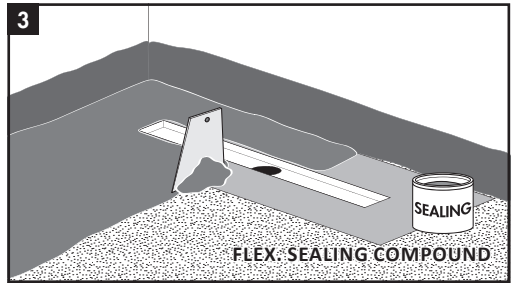
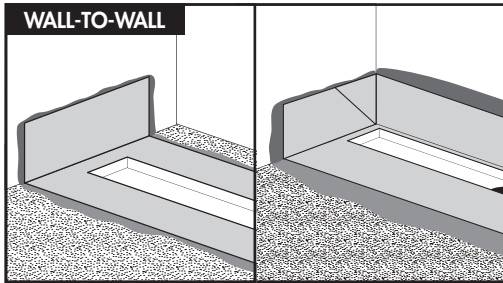
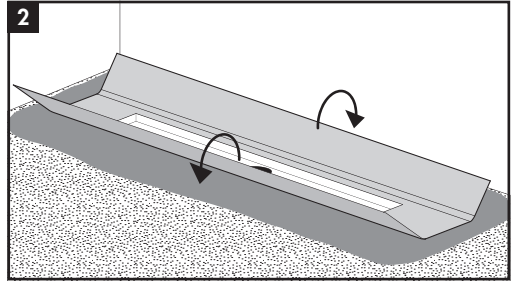
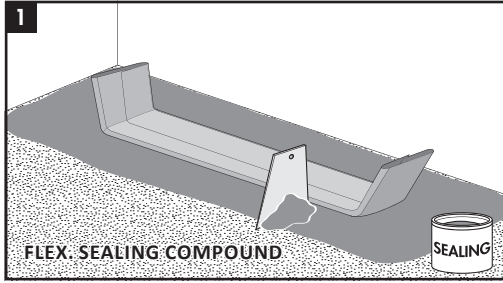

Installation guide | Finishing

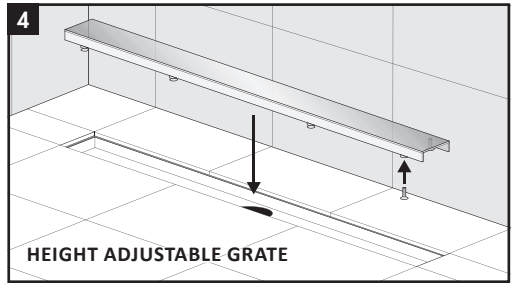
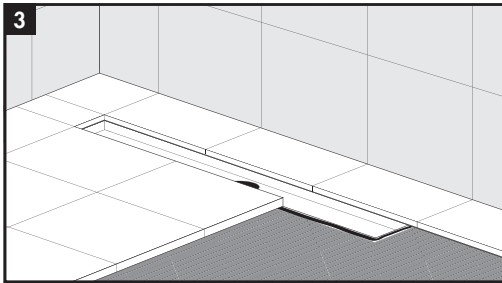
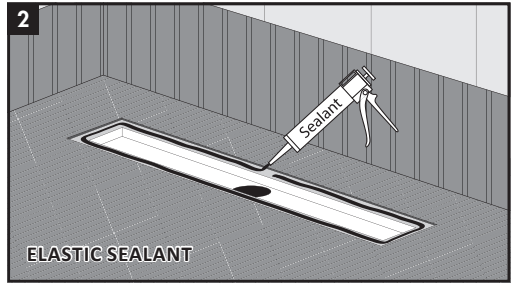
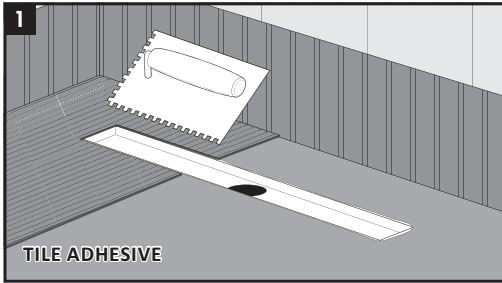

Note: This drain can be installed wall-to-wall, along the wall and between three walls as well. Easy Drain USA recommends a 1" minimum of floor tile installed around the drain (except for wall mounted installation).

WATERMARK

MADE IN BROOKLYN, NEW YORK

WATERMARK

MADE IN BROOKLYN, NEW YORK

350 DeWitt Avenue
Brooklyn, NY 11207 USA

T. 718.257.2800

F. 718.257.2144

info@watermark-designs.com

www.watermark-designs.com

Important: Installer must verify that the drain package is complete and check all rough dimensions prior to installation. Installer should consult local and national standards and is responsible for installing the drain in compliance with local and national codes.