

Waste Valve Clamping Ring Wrench Instructions for Part 6130

Package Contents

The box should contain the following:



42757
Socket 1/2
Hex 1



6130-2100
Spanner Wrench
Socket

Tools Required for Installation

- Socket Ratchet 1/2" Drive
(not Included)

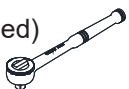

Installation Instructions

1. Place spanner wrench into the clamping ring, insert the 1/2" socket drive into 1" hex on the spanner wrench socket.

Step 1

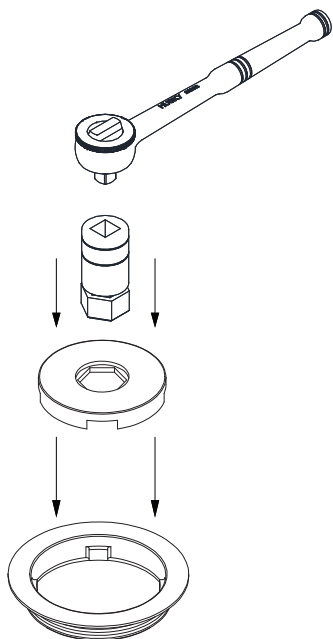

Step 2

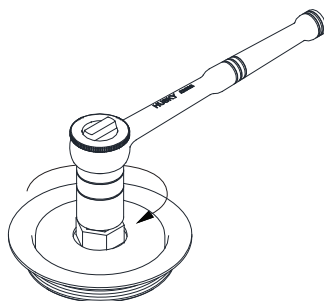

2. Place a socket ratchet with a 1/2" drive onto the socket. Turn clockwise to tighten.

KEEP THIS MANUAL FOR FUTURE REFERENCE



ANSI/A112.18.1M, ANSI/NSF 61.9

Waste Valve Clamping Ring Wrench Instructions for Part 6130

Package Contents

The box should contain the following:



42757
Socket 1/2
Hex 1



6130-2100
Spanner Wrench
Socket

Tools Required for Installation

- Socket Ratchet 1/2" Drive
(not Included)



Installation Instructions

1. Place spanner wrench into the clamping ring, insert the 1/2" socket drive into 1" hex on the spanner wrench socket.

Step 1

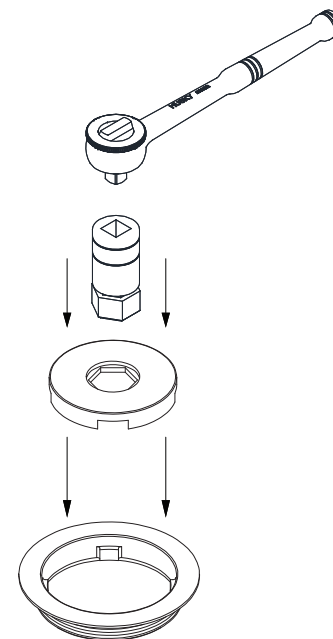

Step 2

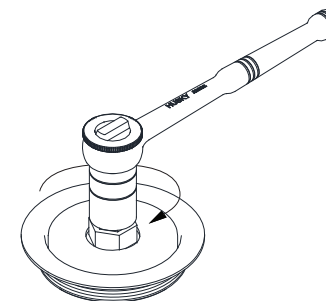

2. Place a socket ratchet with a 1/2" drive onto the socket. Turn clockwise to tighten.

KEEP THIS MANUAL FOR FUTURE REFERENCE



ANSI/A112.18.1M, ANSI/NSF 61.9